

**Reliability —  
Integrated  
Remote  
Controls and  
Metering  
Valves**

The Millennium and Quantum valves were designed, tested and refined simultaneously, so they operate at the same pressures and share common air fittings. There's nothing to adapt, no bushings to reduce, no orifice fittings to mismatch.

The Millennium and Quantum valves share a design philosophy. We design them to last and build them with precision. We incorporated die-cast housings and tough steel actuators.



# Millennium Remote Control System

Reliable, integrated remote control valve and exhaust muffler

Shown here as a simple pressure-release system. Inlet and outlet functions are combined with the Millennium Remote Control Valve.

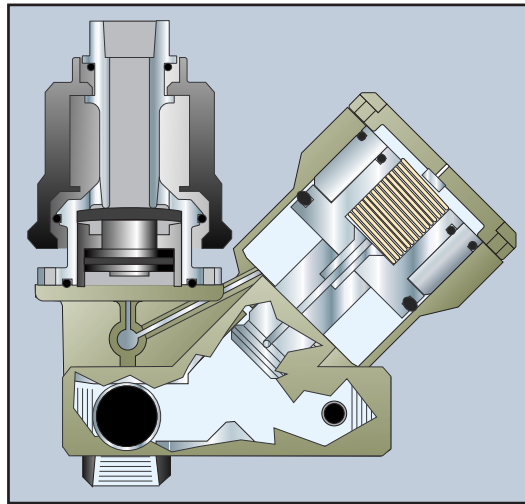

Millennium Remote Control Valve in closed position.

Millennium Remote Control Valve in open position.

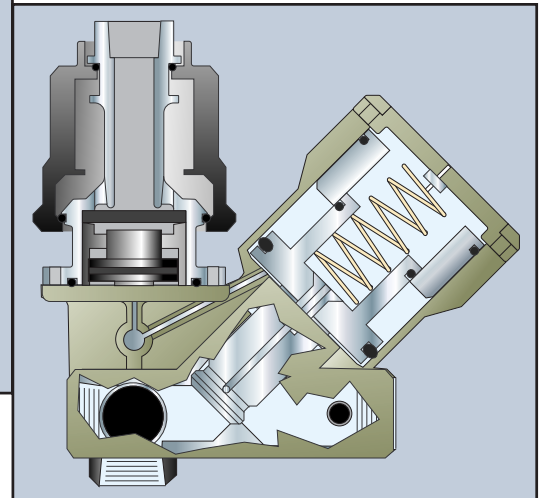

All Contractor Blast Machines come with Clemco's exclusive Millennium pneumatic remote control valve, which combines inlet and outlet functions. It starts and stops faster, so you spend less time waiting, and more time blasting.

Pressing the remote control handle simultaneously actuates both the inlet and outlet portions of the valve. Some systems activate one valve then the other, which can slow response times.

For repetitive short-cycle blasting, order the Contractor Blast Machine configured for pressure-hold operation. It eliminates the delay between the time you actuate the remote control and blasting begins. Also, this system includes an abrasive cutoff switch for remote control actuation of the abrasive flow, which allows air-only blasting to dry surfaces after wetblasting.



The Millennium pneumatic remote control valve combines inlet and outlet functions.



Optional electric remote controls